

TM105 TOWER ASSIST TYRE CHANGER

- Tower assist arm
- Drawer pedal assembly makes after-sale service easier. Reverse switch with silver contractor which secures longer lift in use
- Inflator gauge
- The mounting head is made of 2Dr13, with high strength and precision casting. Wheel rotating device is a standard accessory
- Digital tyre inflator gauge

Voltage	220V/380V	Wheel diameter	1050mm
Power	1.1kw/0.7-0.9kw	N.W	226kg
Rotating speed	6.8/6.8 - 13.6rpm	G.W	195kg
Working bar	0.8 - 1.0Mpa	Operating space	1200 x 1200 x 2000mm
Wheel width	4 - 13"	Packing size	980 x 850 x 890mm
Outside clamp	10 - 22"	Inside clamp	12 - 24"

- Swing arm trye changer
- The streamlined design makes machine more attractive
- Composite body designed to reduce wobble
- Its easy to operate with bead press and press bar
- Drawer pedal assembly makes after-sale service easier



Motor warranty for two years

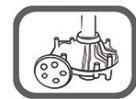

Gear box warranty for two years



12 - 24"

